

Serro Scotty Sportsman HiLander 110V AC Wiring Diagram

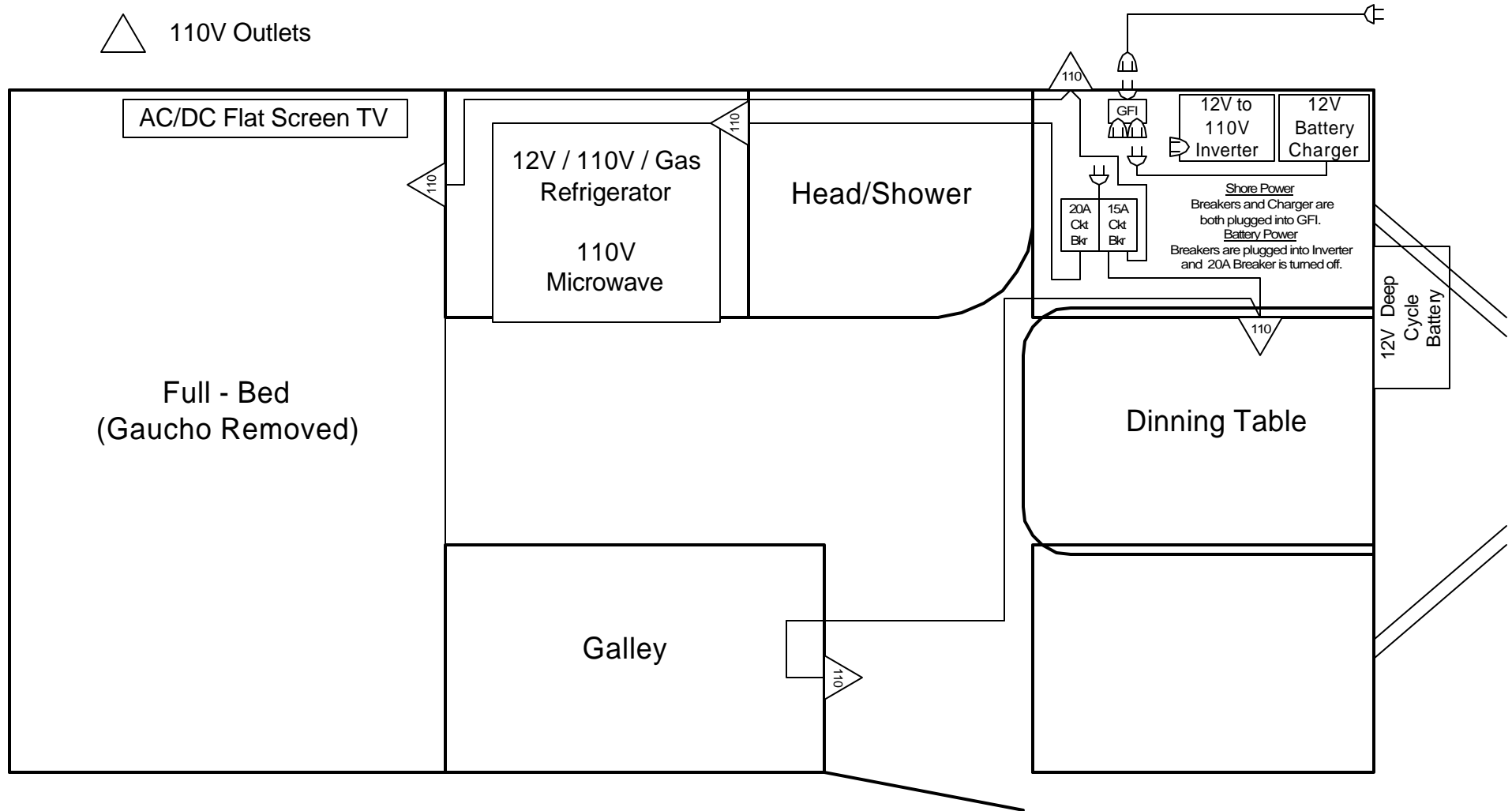

The diagrams contained in this Document are NOT authentic Serro Scotty Drawings.
These Diagrams represent the plans I have for my own 15' Scotty HiLander.

Breaker panel box

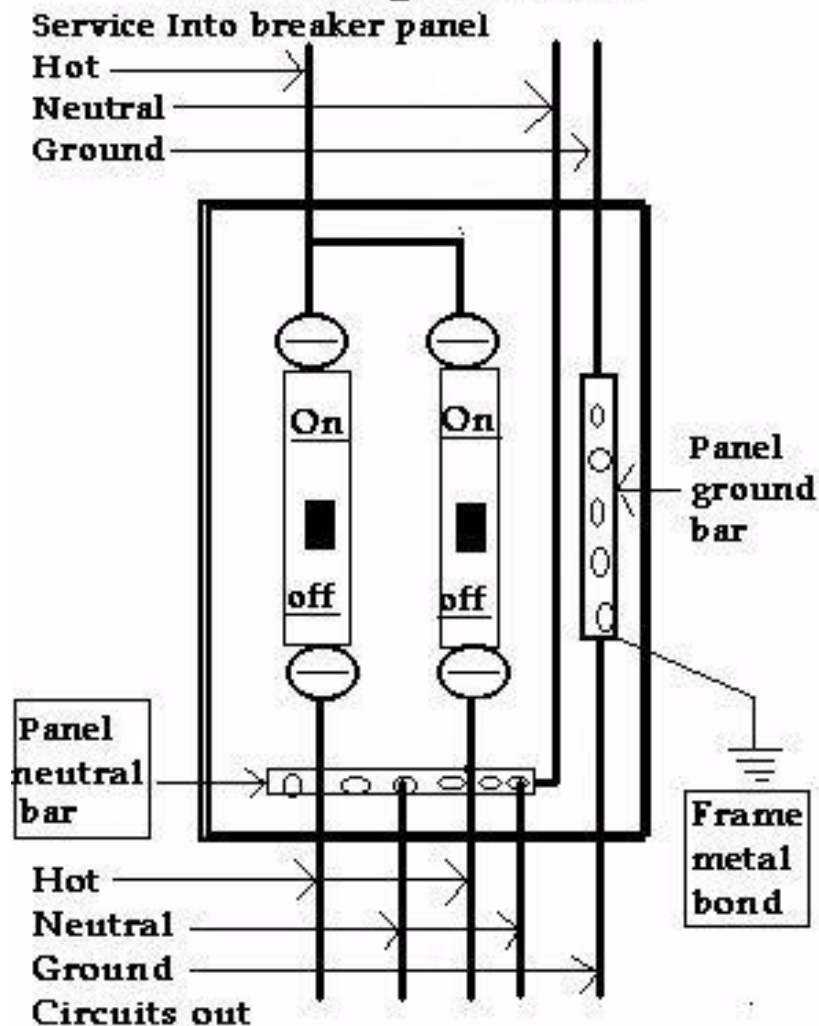

Proper receptable wiring

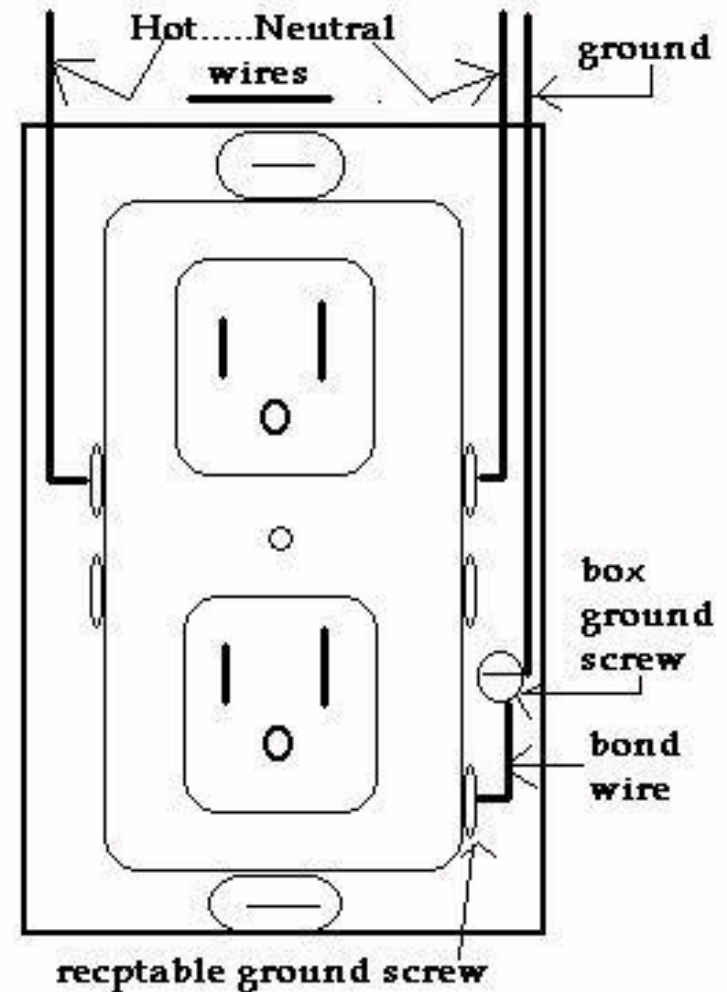

The breaker panel where your power comes in is required to have a ground bar. You will connect the ground wire coming in, as well all the circuit ground wires going to receptables to this ground bar in the breaker panel. All non current carrying metal parts, chassis, frame, must be bonded to the ground bar in the breaker panel box. This also includes, metal gas and water pipes and metal furnaces ducts.

The neutral wire coming into this breaker panel WILL NOT be grounded to this ground bar, as you would normally do in residential homes. Instead, the neutral wire will be grounded on the campground outlet side. If there is a screw connecting neutral terminal bus bar to the breaker panel ground, it must be removed. If you don't do this, the GFCI in the campground panel will blow. If you have a cooking unit, and it has a bonding strap for the neutral, it must be removed and have an equipment ground, (a 4th wire) added, this is usually for only 220V appliances, which in a house just have 3 wires, but in a trailer must have 4. But this really does not apply to Scottys.

Credit for above drawings and this information: Larry(foxxone@yahoo.com)

▭ Porch Light

▭ Fluorescent Lights

○ Ceiling Vent w/Fan

△ 12V Outlet

Serro Scotty Sportsman 12V DC Wiring Diagram

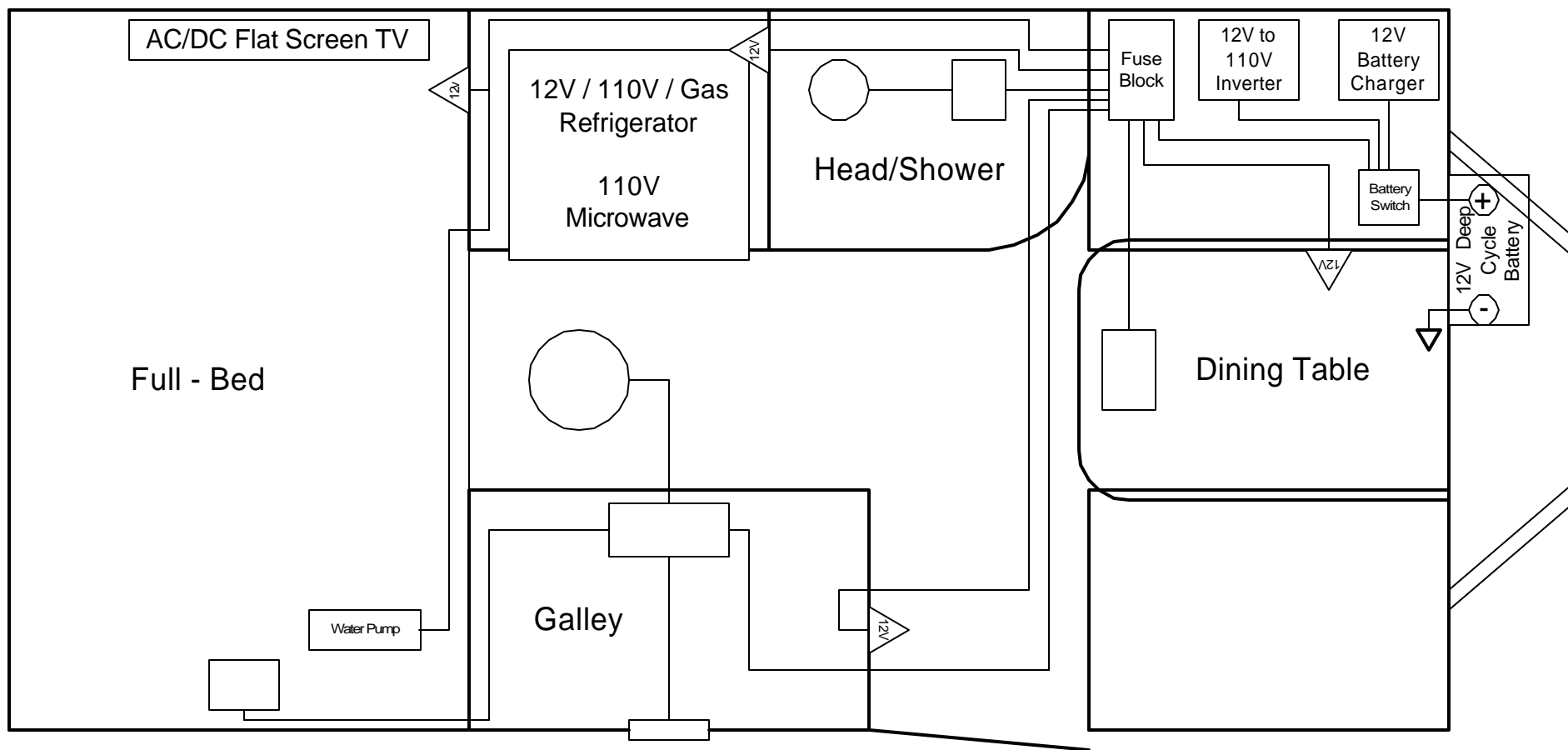

- 1 Humphrey Lamp
- 2 Heater Buddy
- 3 Outside Camp Stove
- 4 Inside Gas Stove
- 5 Water Heater
- 6 Refrigerator

Serro Scotty Sportsman Gas Lines Diagram

- Gas "T" Connector
- Shut-Off Valve
- △ Gas Connection
- ▲ 1lb to 20lb LP Tank Adapter

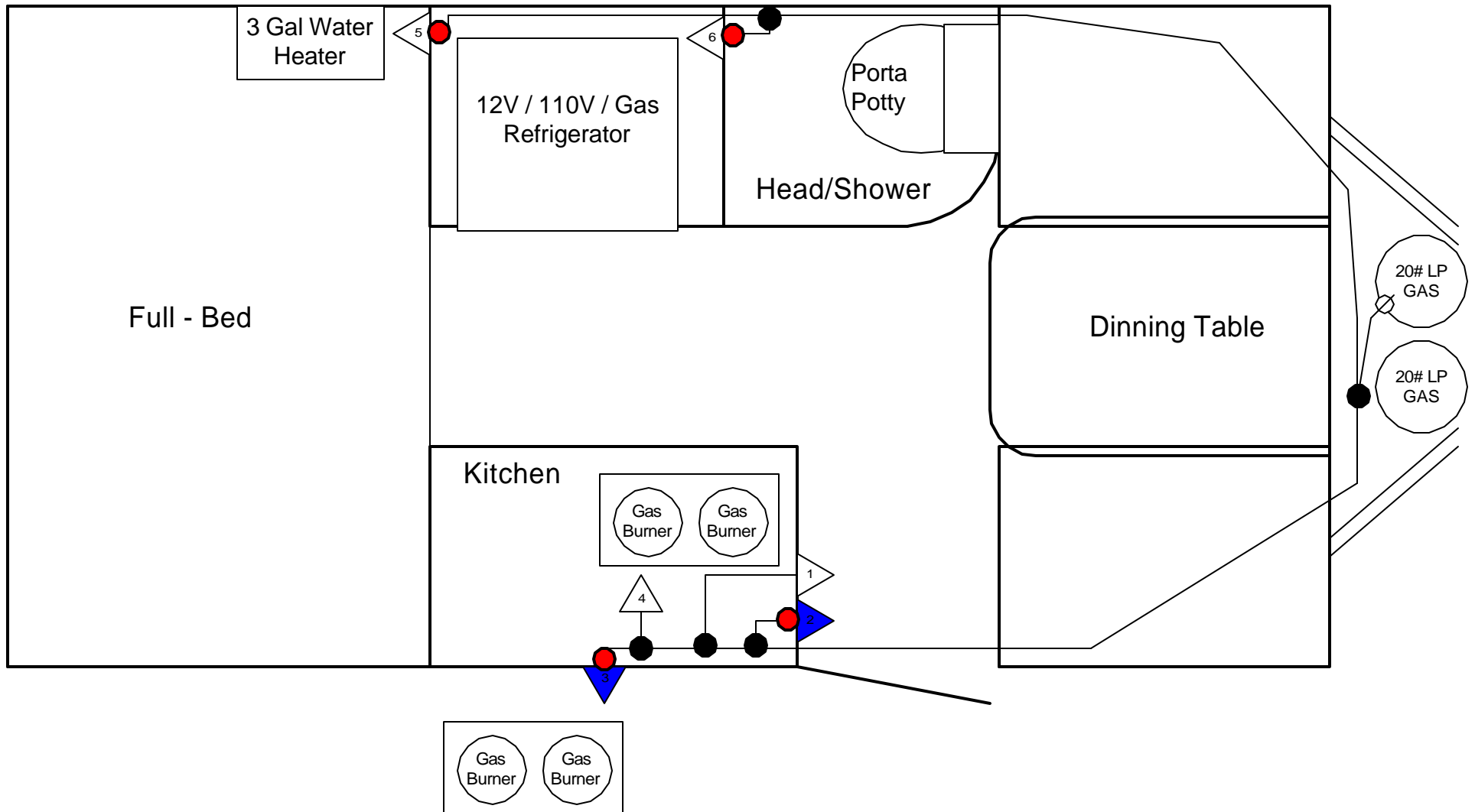

- △ 1 Hot Galley Faucet
- △ 2 Cold Galley Faucet
- △ 3 Hot Shower Faucet
- △ 4 Cold Shower Faucet
- △ 5 City Water Connection
- △ 6 Water Tank Fill Pipe
- 7 Galley Sink Drain
- 8 Shower Floor Drain
- 9 Grey Water Bucket Drain

Serro Scotty Sportsman Plumbing Diagram

- Gray Water Connections
- △ Fresh Water Connections

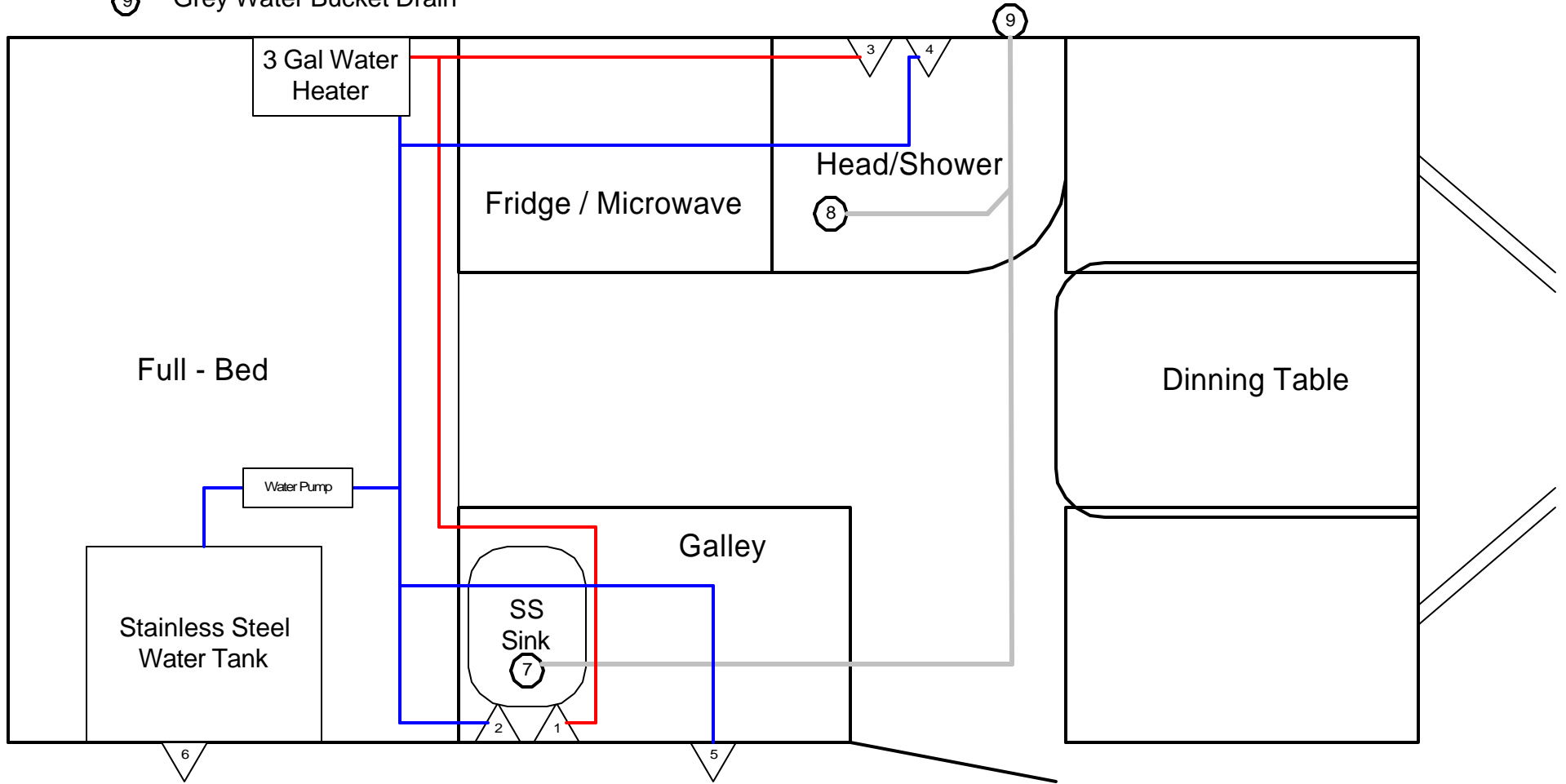

- 1 Amber Clearance Lights
- 2 Red Running Lights
- 3 Red Turn/Brake Lights
- 4 White Backup Lights
- 5 White License Plate Light

- 1 White Ground
- 2 Blue Brakes
- 3 Green Running Lights
- 4 Black 12 Volt Power
- 5 Red Left Brake/Turn
- 6 Brown Right Brake/Turn
- 7 Yellow Auxilary / Backup

Note: This color coding is only for 7-pin round connector. The color codes for 4-pin flat and 6-pin square connectors are different

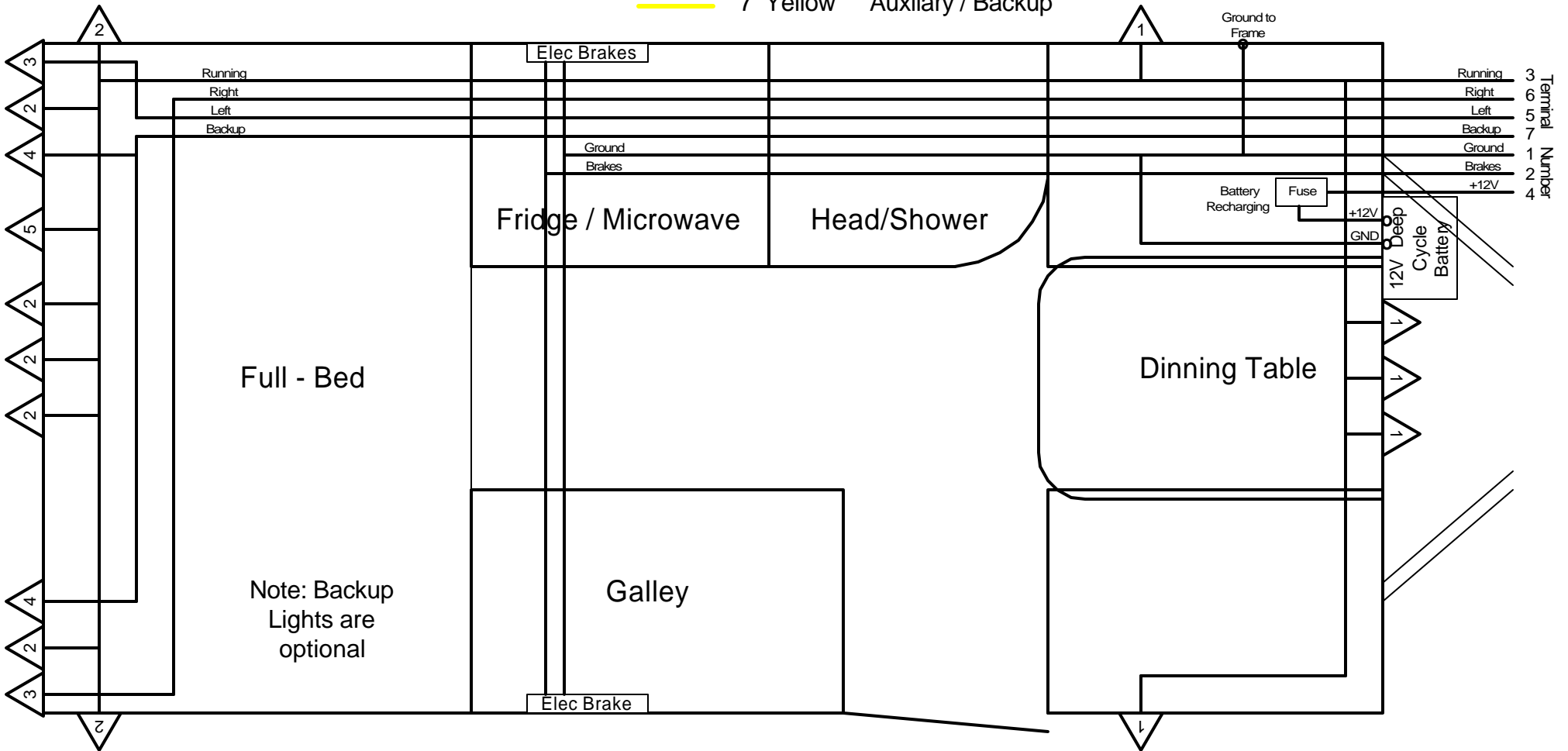

Serro Scotty Sportsman Running Lights Wiring Diagram

Note: 12V Battery Charging Ckt from Tow Vehicle must be connected to a relay which disconnects charging ckt when engine is off